

MARK

ANOTHER
ARCHITECTURE

JUNE / JULY 2008

#14

NEW
RAW
WINNERS

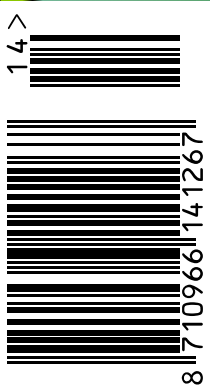

MARK

WINNER
EUROPEAN DESIGN
AWARD 2008
'A truly 21st century magazine'
*EDAWARDS
EUROPEAN DESIGN

MARK #14
JUNE / JULY 2008

EUROPE €19.95 / UK £ 14
JAPAN ¥ 3,570 / KOREA 40,000 WON
CANADA \$ 29.50 / USA \$ 24.95

BY THE MAKERS OF
FRAME

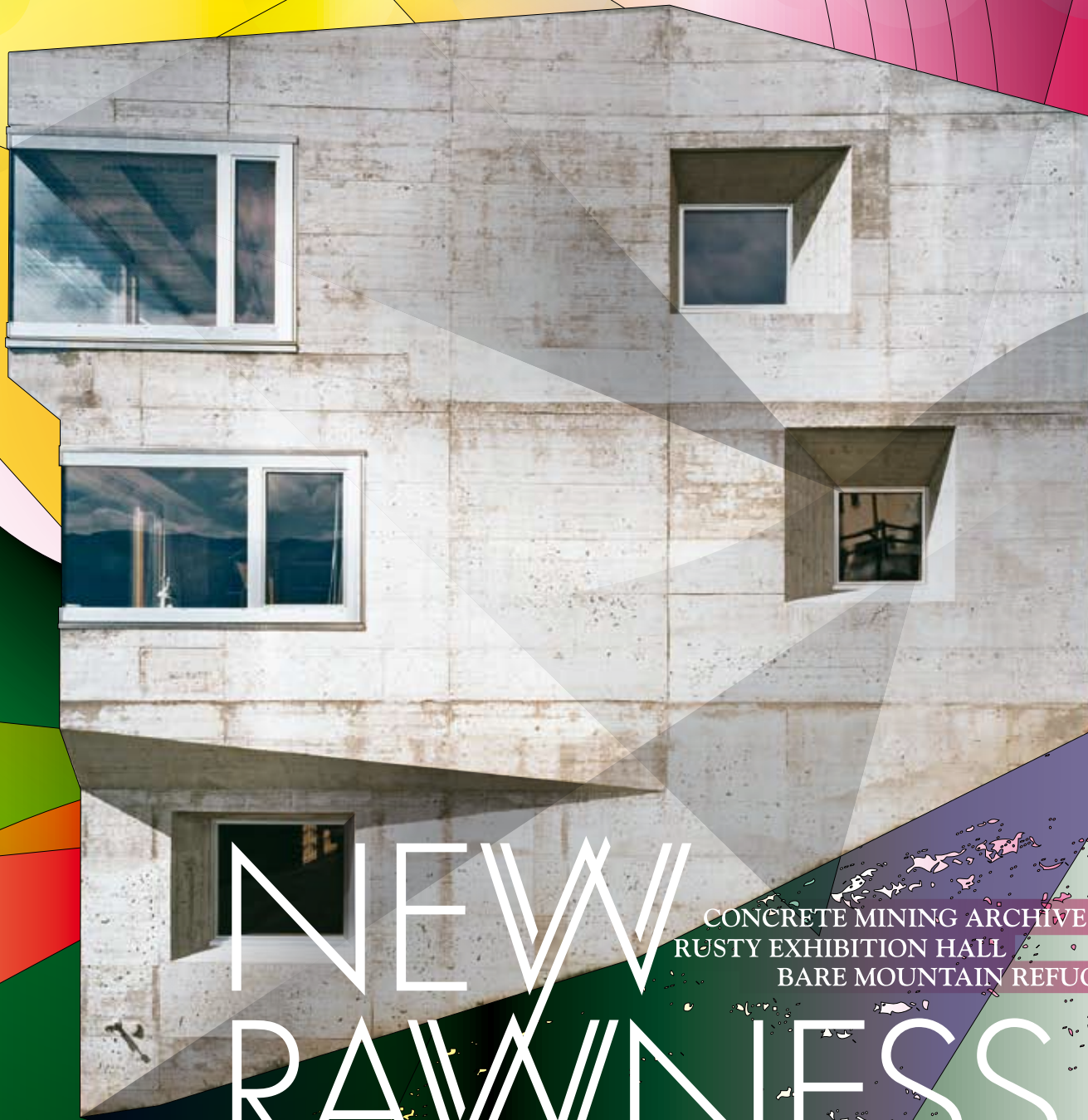

NEW RAW WINNERS

CONCRETE MINING ARCHIVE
RUSTY EXHIBITION HALL
BARE MOUNTAIN REFUGE

NOTICE BOARD

WHAT'S HAPPENING



01



02

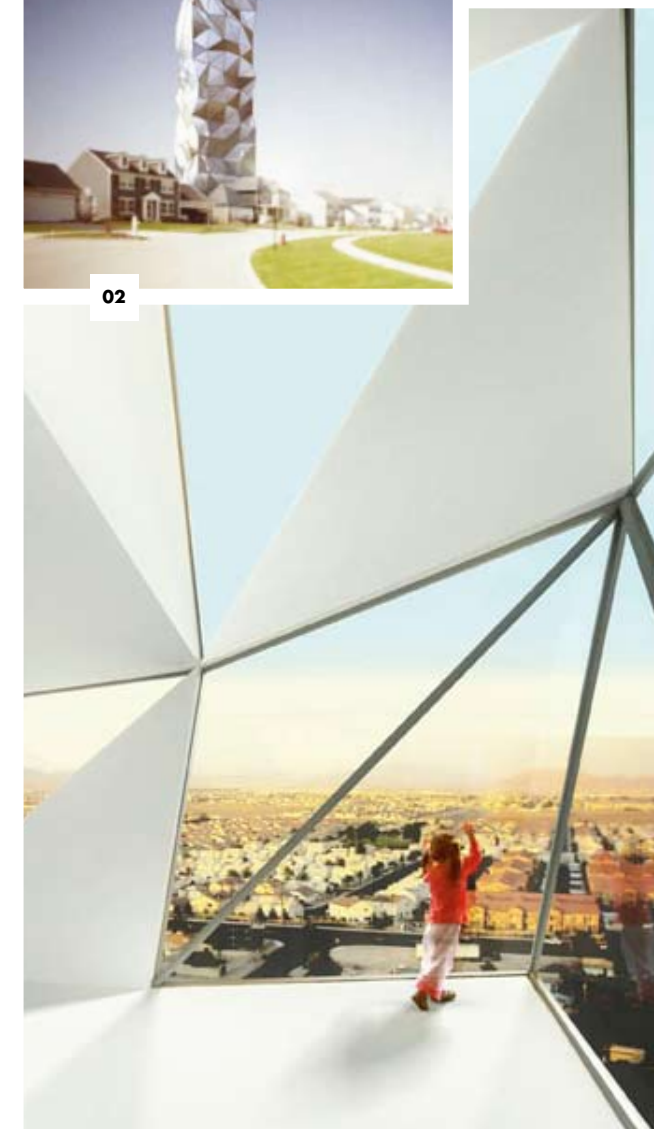

03



04



07



09

01 CORSO MARCHE

Turin, Italy / Research and development centre for aerospace companies / Studio Amati / Expected completion undisclosed / www.studioamati.it

02 BROKEN MIRRORS

Kansas City, MO, USA / Condominium / Dahm Architects / Design competition entry / www.dahmstudio.com / Rendering by Studiosezz

03 NORTH ARCHIVES

Lille, France / Archive building / X-TU architects / Design competition entry / www.x-tu.com / Rendering by Platform

04 WARP

Paris, France / 'A vertical deformation of the time-space continuum, questioning the possibility of a skyscraper in a historic city' / Keeyoung LEE + Nenad BASIC architects / Design competition entry / www.keeyonglee.com / www.nenadbasic.com

NOTICE BOARD
MARK #14/2008



05



06



08

05 SPORTS HALL

Loveno (Como), Italy / Sports hall with a steel net façade for vegetation / Riccardo Salvi and Thore Schaier / Design competition entry / www.logica-architettura.it / www.thoreschaier.com

06 KING FAHAD NATIONAL LIBRARY

Riyadh, Saudi Arabia / National Library with filigree textile façade / Gerber Architekten / Expected completion 2010 / www.gerberarchitekten.de

07 HOLLERICH DISTRICT

Luxembourg / Offices, housing and retail / Manuelle Gautrand / Design competition entry / www.manuelle-gautrand.com / Rendering by Platform

08 ARTPARK PAVILION

Rotterdam, the Netherlands / Art pavilion / WHIM Architecture (Ramon Knoester) / Design competition entry / www.whim.nl

09 RUE SAINT DOMINIQUE

Paris, France / Social housing block with 31 units / Beckmann-N'Thépé Architects / Expected completion 2010 / www.b-nt.biz / Rendering by Alain Deswarte

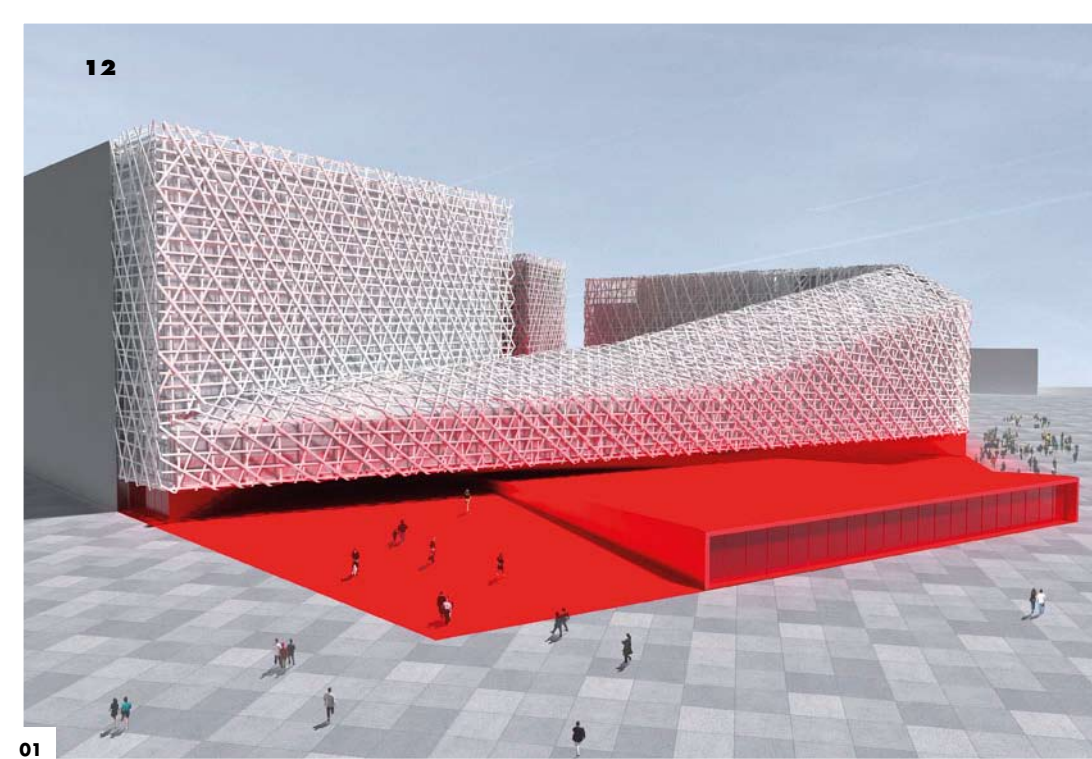

01



02



03



04

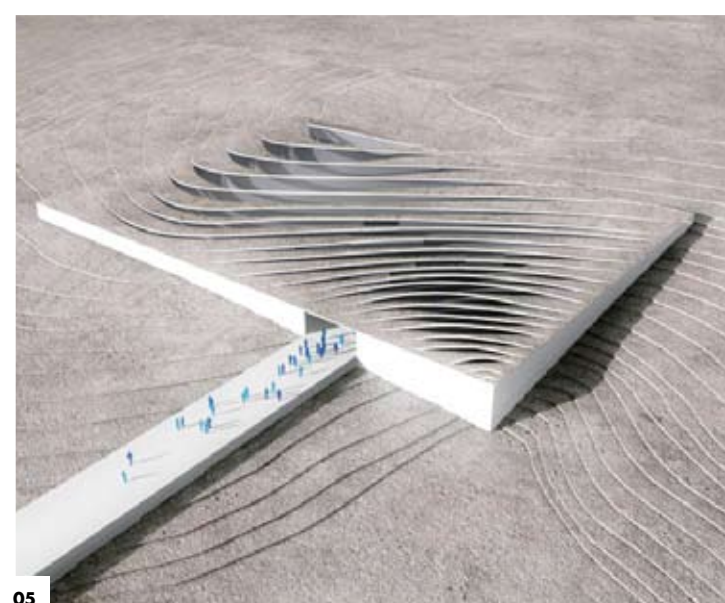

05

01 EUROPEAN SOLIDARITY CENTER (ESC)

Gdansk, Poland / Exhibition spaces, offices, shops, café, restaurant, winter garden and public amenities to commemorate the Solidarity (Solidarnosc) Movement / Keeyong LEE + Nenad BASIC architects / Restricted design competition entry, finalist / www.keeyonglee.com / www.nenadbasic.com

02 GREAT BERLIN WHEEL

Berlin, Germany / Observation Wheel / Ingo Pott / Expected completion 2009 / www.pottarchitects.com / Rendering by Rudi Meisel

03 CONCRETE CANOPY

Saint Cyprien, France / Auditorium and movie theatre / Serero Architects with Taichi Sunayama and Lionel Léotardi / Design competition entry, first prize / www.serero.com

04 AIR TRAFFIC CONTROL

Ljubljana, Slovenia / Air traffic control centre and airport tower / SVA (Jurij Sadar, Boštjan Vuga, Špela Štern, Miha Cebulj, Aleksandar Lalic) / Expected completion 2010 / www.sadarvuga.com

05 ALICE IN WONDERLAND

Beirut, Lebanon / Museum of contemporary art / Dahm Architects / Design competition entry / www.dahmstudio.com / Rendering by Studioezz



06



08

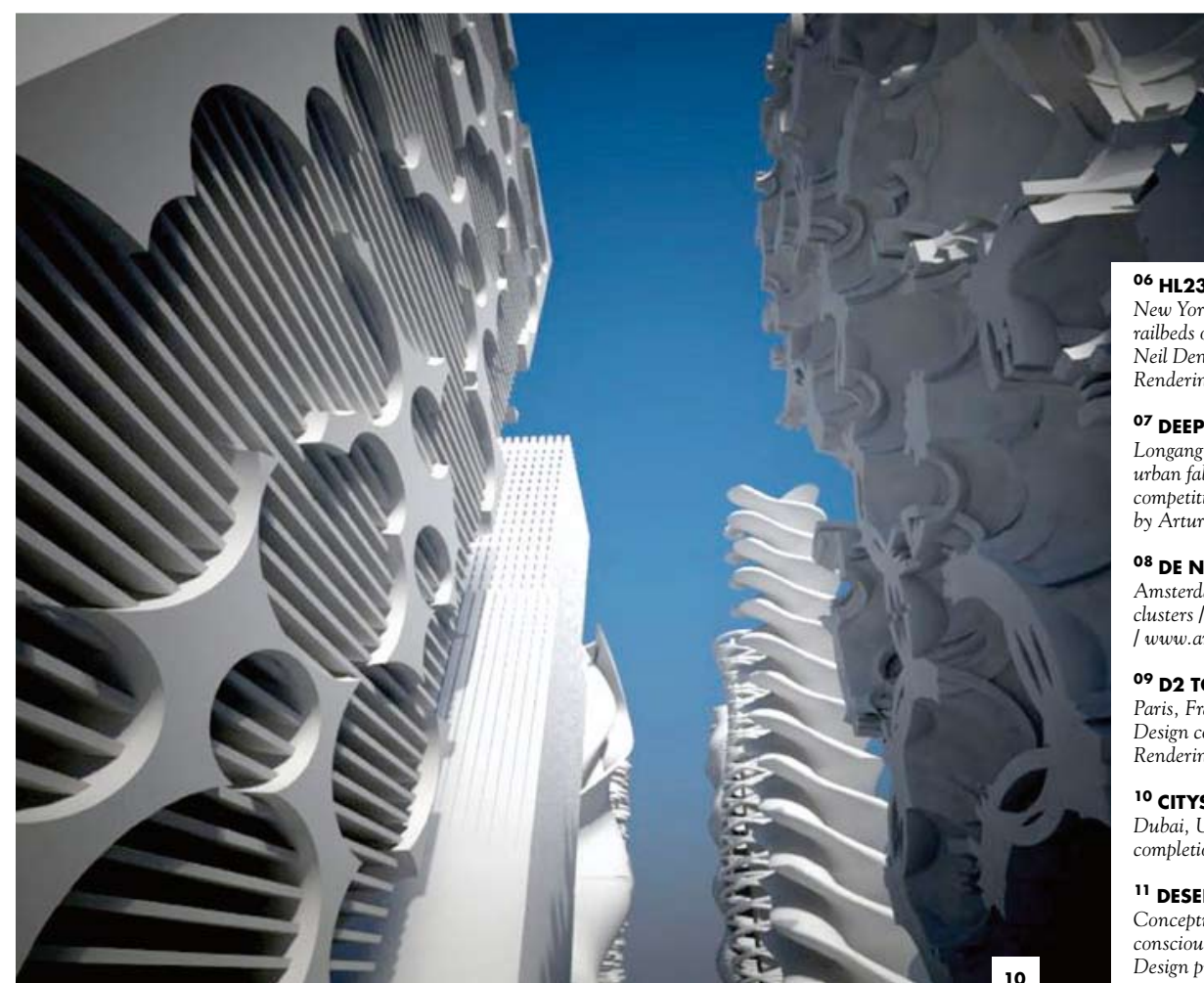

10

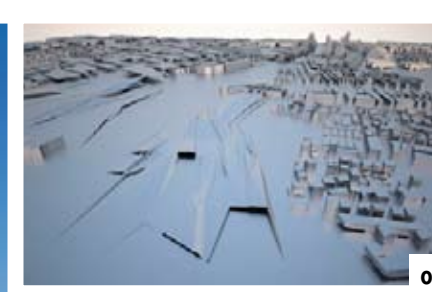

07

NOTICE BOARD
MARK #14/2008



09

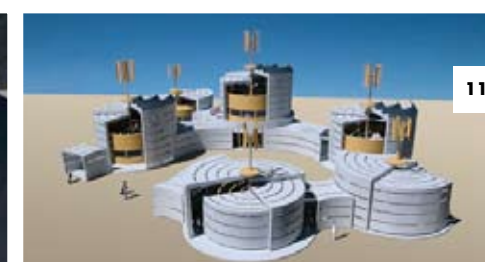

11

06 HL23

New York, NY, USA / Condominium that rises from below the railbeds of the historic High Line on Manhattan's West Side / Neil Denari / Expected completion 2009 / www.nmda-inc.com / Rendering by Hayes Davidson

07 DEEP GROUND

Longang, Shenzhen, China / Regeneration of 11.8 km² of the urban fabric in the centre of Longang / GroundLab / Design competition entry, first prize / www.groundlab.org / Rendering by Arturo Lyon

08 DE NIEUWE SENECA

Amsterdam, the Netherlands / Comprehensive school and care clusters / Arons en Gelauff architects / Expected completion 2011 / www.aronsengelauff.nl

09 D2 TOWER

Paris, France / Office tower in La Défense / Manuelle Gautrand / Design competition entry / www.manuelle-gautrand.com / Rendering by Platform

10 CITYSCAPE

Dubai, UAE / Towers / Elenberg Fraser / Master plan, expected completion undisclosed / www.e-f.com.au

11 DESERT WINDS ECO SPA

Conceptual design study for a small scale, environmentally conscious, solar and wind powered facility / Michael Jantzen / Design proposal / www.humanshelter.org



01



02



03



04

- 01 CONCERT HALL**
Malmö, Sweden / Exhibition and concert hall, housing, restaurant, industry, hotel, shopping and cafes / Schmidt Hammer Lassen / Design competition entry, first prize / www.shl.dk
- 02 STAEDEL MUSEUM**
Frankfurt am Main, Germany / Underground extension of the Staedel Museum / Schneider + Schumacher / Design competition, first prize / www.schneider-schumacher.de
- 03 PWKGE**
Gelsenkirchen, Germany / Pumping station for a tunnelled river / bK (bueroKleinekort) and tor5architects / Design competition entry / www.kleinekort.com / Rendering by avpgroup
- 04 CHAUMONT DE JANEIRO**
Chaumont sur Marnes, France / International center of graphism / Stéphane Maupin / Expected completion 2010 / www.stephanemaupin.com / Rendering by Fantastic office



05



07

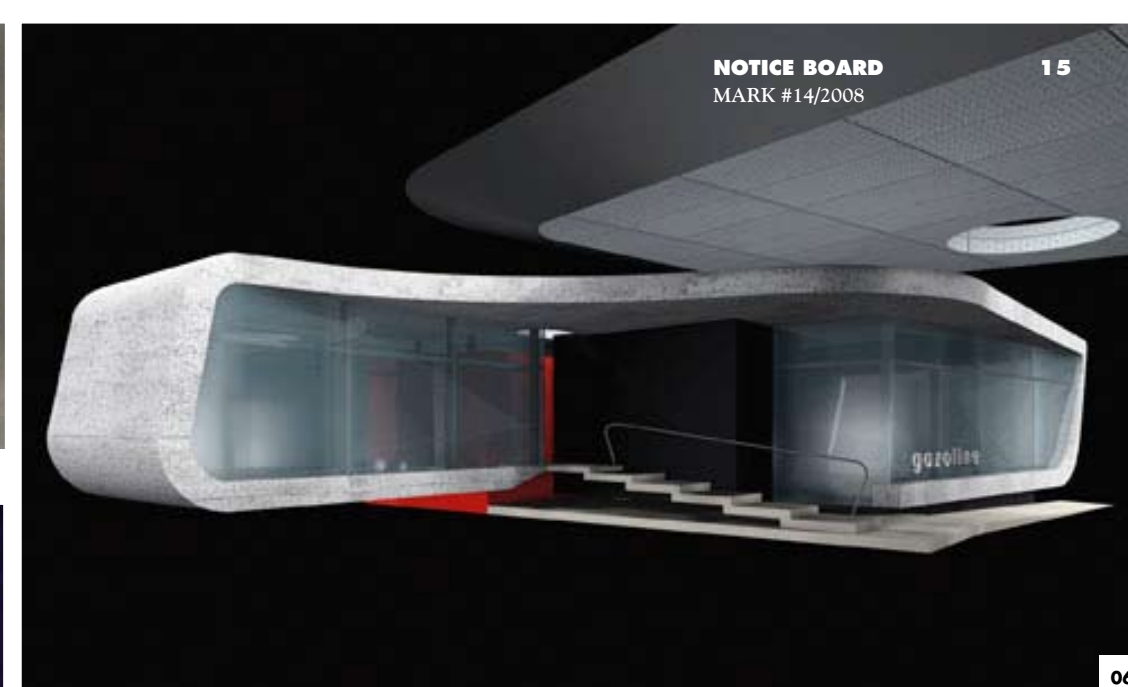

06



08

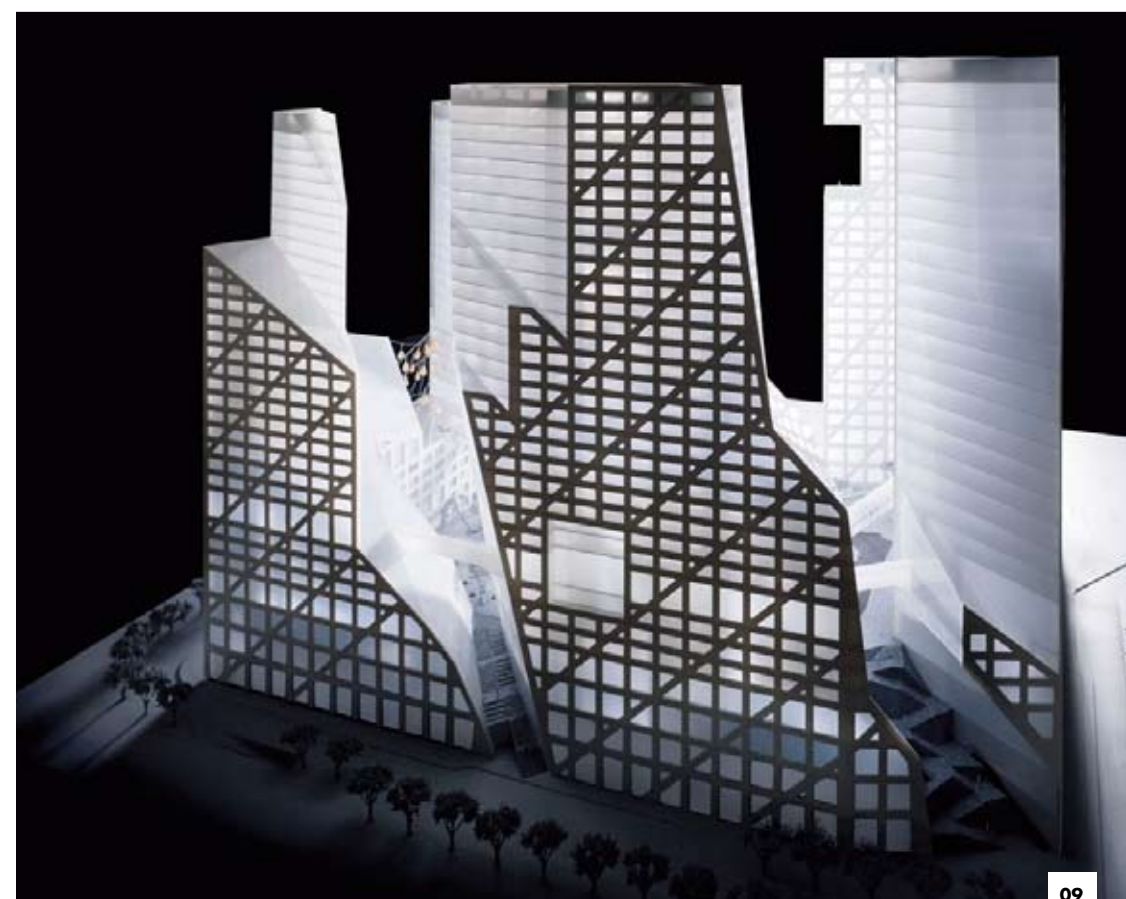

09

- 05 THE MERSEY OBSERVATORY**
Liverpool, UK / Public Observation Tower / Phos Architects / Expected completion 2011 / www.phosarchitects.co.uk
- 06 GAZOLINE**
Cuneo, Italy / Petrol station and café / Duilio Damilano, Alberto Pascale and Claudia Allinio / Design proposal / www.damilanostudio.com
- 07 CONCERT HALL**
Ljubljana, Slovenia / Opera and concert hall with offices, apartments, retail spaces, restaurants, party rooms and underground parking / Neutelings Riedijk Architects / Expected completion 2012 / www.neutelings-riedijk.com
- 08 CANOPY, A SHAPE IN EQUILIBRIUM**
Paris, France / Renovation of transport hub and shopping centre Les Halles / Berger & Anziutti Architects / Design competition entry, first prize / www.berger-anziutti.com
- 09 SLICED POROSITY BLOCK**
Chengdu, China / Five towers with offices, serviced apartments, retail, hotel, cafés and restaurants / Steven Holl Architects / Expected completion 2010 / www.stevenholl.com